

Function Room Three



A versatile and functional room that can be used for meetings, workshops, or breakout space.



SUPPORTED BY



AFFILIATED WITH



Registered Number 1368325 | Charity Registration Number 275961

| Different every day

Function Room Three

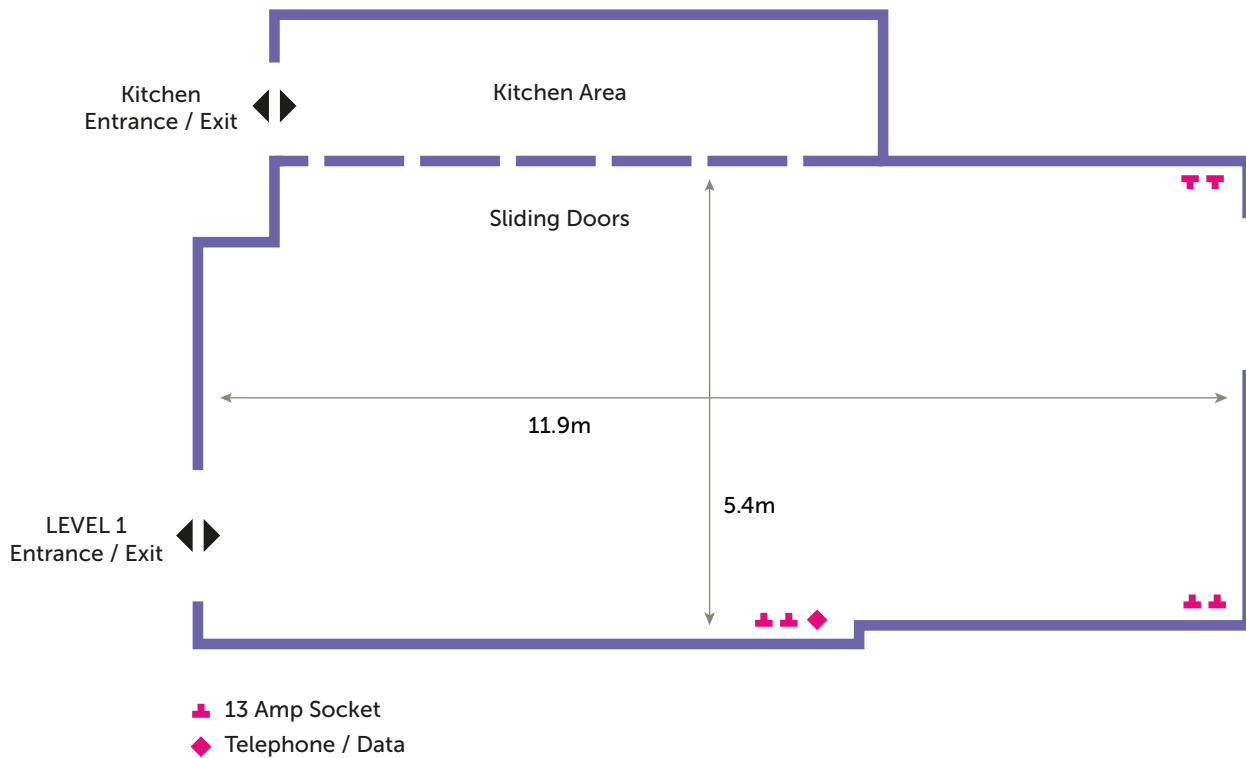

Full technical specification in request

LEVEL

Level in building **1**

TYPE OF ROOM /SPACE

Meetings
Rehearsals
Receptions

DIMENSIONS (M)

Total square area [sq m] **64.26**
 Max length **11.9m**
 Maximum width **5.4m**

CAPACITIES

Boardroom **15**
 U-shaped **15**
 Classroom **20**
 Theatre style **40**
 Drinks reception (no tables) **60**
 Drinks reception (tables) **50**
 Max (no furniture) **70**

LIGHTING

Natural Light **Yes**
 Blackout possible **Partial**
 Dimmable lighting **Yes**

POWER

13 amp sockets **4**

TECH

50 inch LED display screen
 In ceiling PA System
 VGA, HDMI presenting capability
 Infrared hearing loop system
 2 microphones
 Extra Equipment available
 Dedicated conference wifi

ACCESS

Direct street level load in	Ramped
Direct lorry level load in	No
Min load in aperture	1.5m x2.4m
Wheelchair access	Yes
Disabled toilets	Yes
Lift to foyers	Yes x 2
Toilet facilities (in room)	No
Toilet facilities (in suite of rooms)	Yes

For details about hiring this space, please contact our Corporate Development Executive on **01202 781319** or email lucy.funnell@lighthousepoole.co.uk

SUPPORTED BY



AFFILIATED WITH



Registered Number 1368325 | Charity Registration Number 275961

| Different every day

Function Room Three



For details about hiring this space, please contact our Corporate Development Executive on **01202 781319** or email lucy.funnell@lighthousepoole.co.uk

SUPPORTED BY



AFFILIATED WITH



Registered Number 1368325 | Charity Registration Number 275961