

# Function Room One

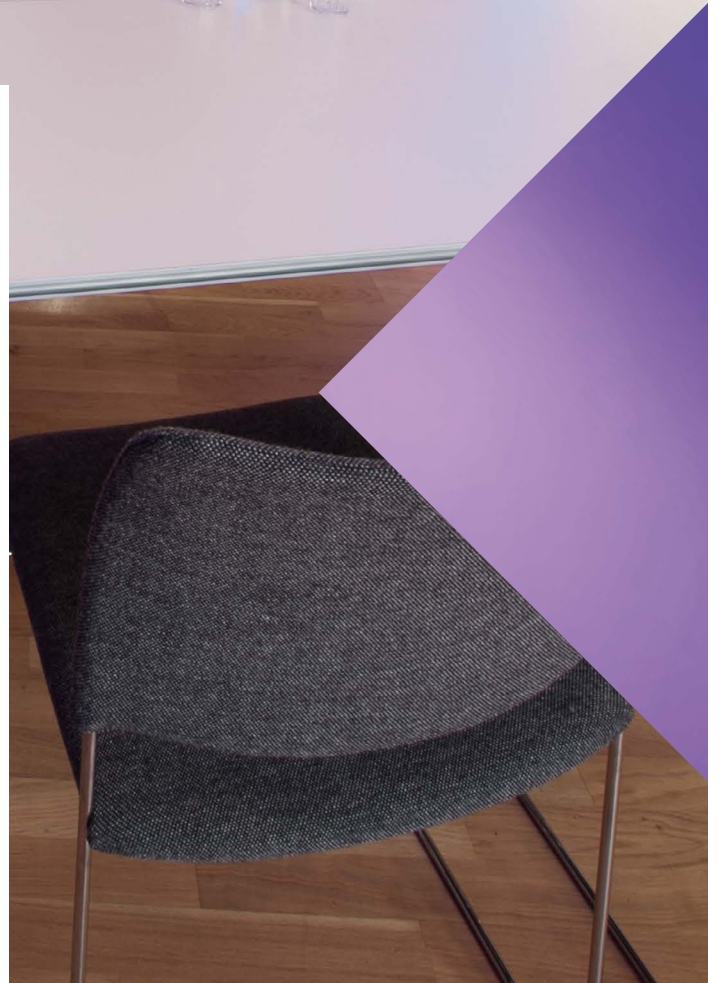

A versatile and light room with views overlooking Poole. Ideal for meetings, training days and workshops, this room can also be combined with Function Room 2.



SUPPORTED BY



AFFILIATED WITH



Registered Number 1368325 | Charity Registration Number 275961

**| Different every day**

# Function Room One

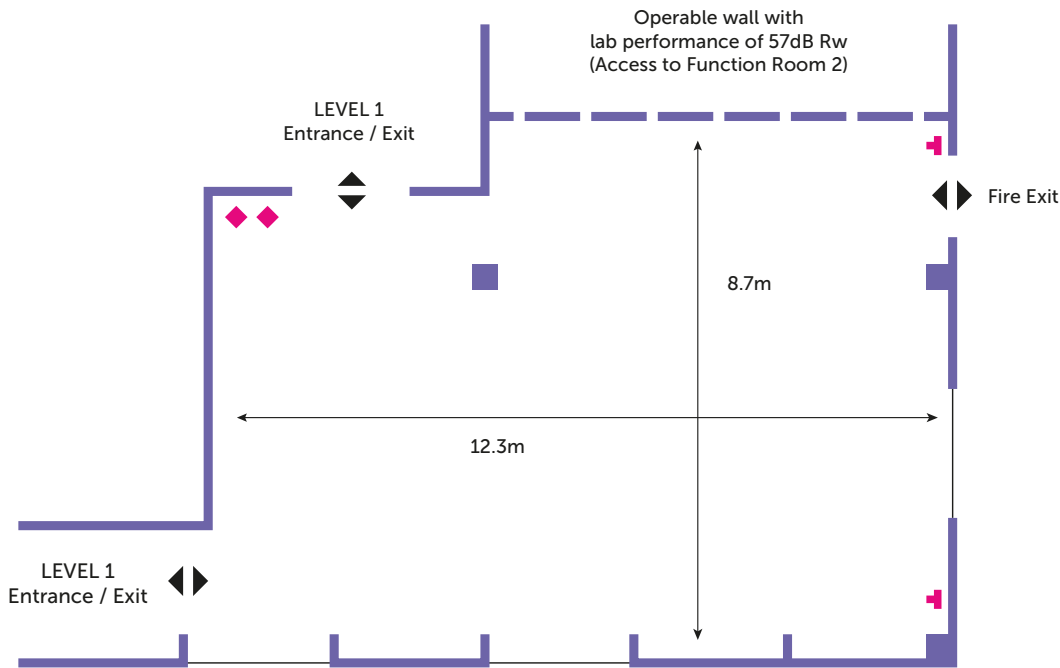

- ⊕ 13 Amp Socket
- ◆ Telephone / Data

Full Technical specification on request

## LEVEL

Level in building **1**

## LIGHTING

Natural Light **Yes**  
 Blackout possible **Partial**  
 Dimmable lighting **Yes**  
 Lighting **6 way lighting bar**

## TYPE OF ROOM /SPACE

Meetings  
 Rehearsals  
 Receptions

## DIMENSIONS (M)

Total area (sq m) **107**  
 Max length **12.3m**  
 Max width **8.7m**  
 Max height **3**

## CAPACITIES

Boardroom **20**  
 U-shaped **20**  
 Classroom **30**  
 Theatre style **50**  
 Drinks reception (no tables) **100**  
 Drinks reception (tables) **50**  
 Max- no furniture **120**

## POWER

13 amp sockets **4**

## TECH

Ceiling mounted HD projector  
 2.6m Electric projector screen  
 In ceiling Pa System  
 iPad mini in wall wireless control system  
 VGA, HDMI or wireless presenting capability  
 Infrared hearing loop system  
 2 microphones  
 Extra Equipment available  
 Dedicated conference Wifi

## ACCESS

Direct street level load in **Ramped**  
 Direct lorry level load in **No**  
 Min Load in aperture **1.5m x 2.4m**  
 Wheelchair access **Yes**  
 Disabled toilets **Yes**  
 Lift to foyers **2**  
 Toilet facilities (in room) **No**  
 Toilet facilities (in suite) **Yes**

For details about hiring this space, please contact our Corporate Development Executive on **01202 781319** or email [lucy.funnell@lighthousepoole.co.uk](mailto:lucy.funnell@lighthousepoole.co.uk)

SUPPORTED BY



AFFILIATED WITH



Registered Number 1368325 | Charity Registration Number 275961

**| Different every day**

# Function Room One

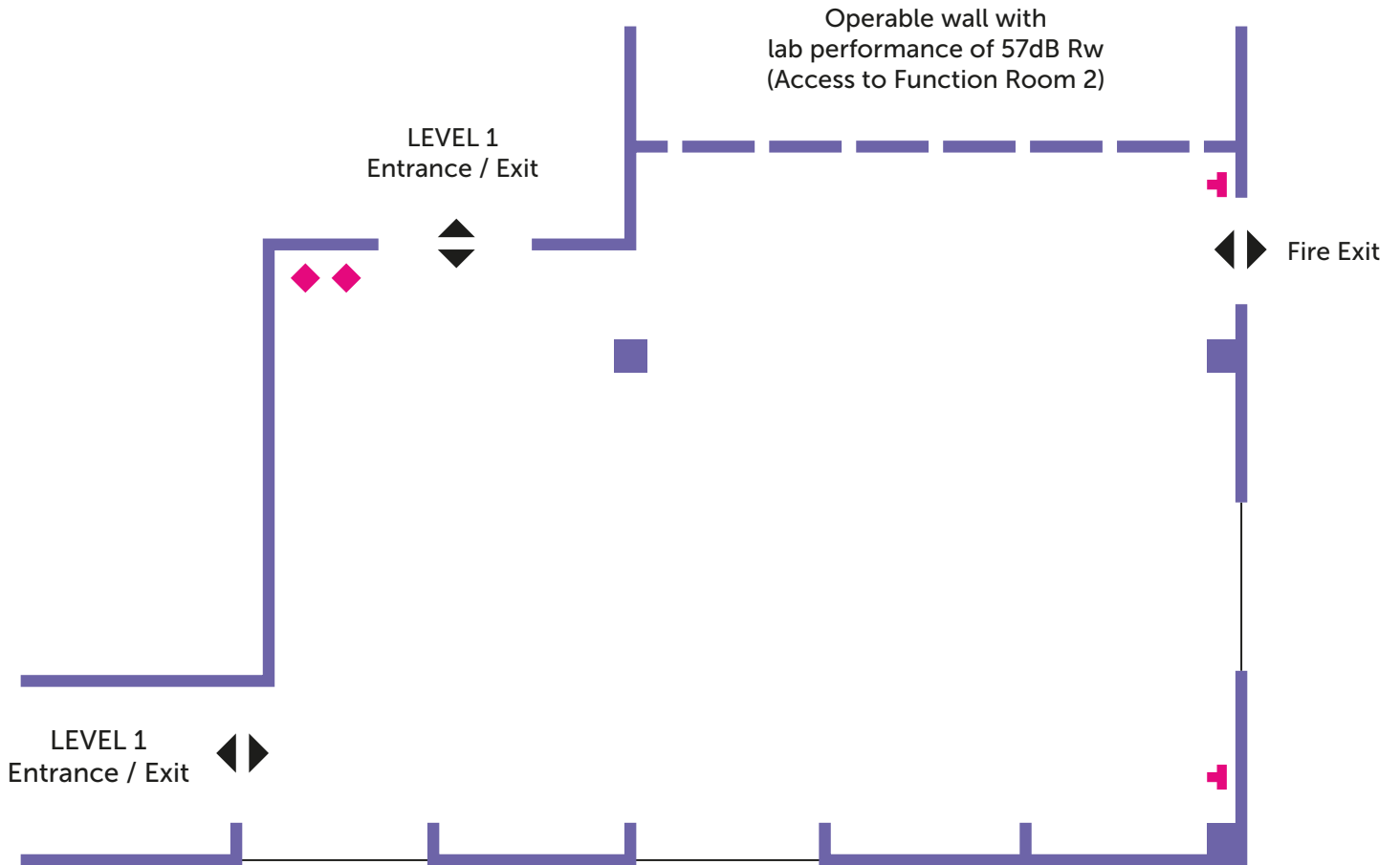

- 13 Amp Socket
- ◆ Telephone / Data

For details about hiring this space, please contact our Corporate Development Executive on **01202 781319** or email [lucy.funnell@lighthousepoole.co.uk](mailto:lucy.funnell@lighthousepoole.co.uk)

SUPPORTED BY



AFFILIATED WITH

Registered Number 1368325 | Charity Registration Number 275961

**| Different every day**